

Omega System

Combining timeless design with proven quality

Omega System

- Partition thickness: 100 mm
- Module width: 1200mm
- Prefabricated, non-supporting construction
- Studs: thermically galvanised steel (Sendzimir process) with a minimum zinc coating of 60 g/m² for the whole surface; cutouts for cable and water ducts.
- Visible profiles: extruded Aluminium, powder coated
- The ceiling track offers an integrated picture rail for paintings, etc.
- PVC infill strips in various colours
- 2 x 12.5 mm plaster board panels (for OMEGA VIP: 2x 2 x 12.5 mm plaster board panels)
- Wall covering: Vinyl/Textile/laminate/veneer
- Insulation: 40 mm mineral wool
- Glass elements single- or double glazed
- recessed aluminium skirting
- Height: till 8000 mm, subject to conditions

Doors:

- Flush hollow-core chipboard or solid wood
- 880 mm or 930 mm or with over panel
- 880 mm or 930 mm, room high

The sound insulation value for the standard execution is R_w 46dB (ISO 717).

Fire resistance has been tested by TNO, the Dutch Institute for Applied Natural Sciences in Delft, according to the actual European norms. With a few simple adaptations a fire resistance of 30 minutes can be achieved.

The partition system Omega-VIP consists of a double layer of plaster board panels and is especially suitable for those areas where high values of sound insulation are required. The sound insulation value for the Omega-VIP execution is R_w 49 dB (ISO 717).

Some simple adaptations are necessary to increase the fire resistance in the VIP-version to a level of 60 minutes.

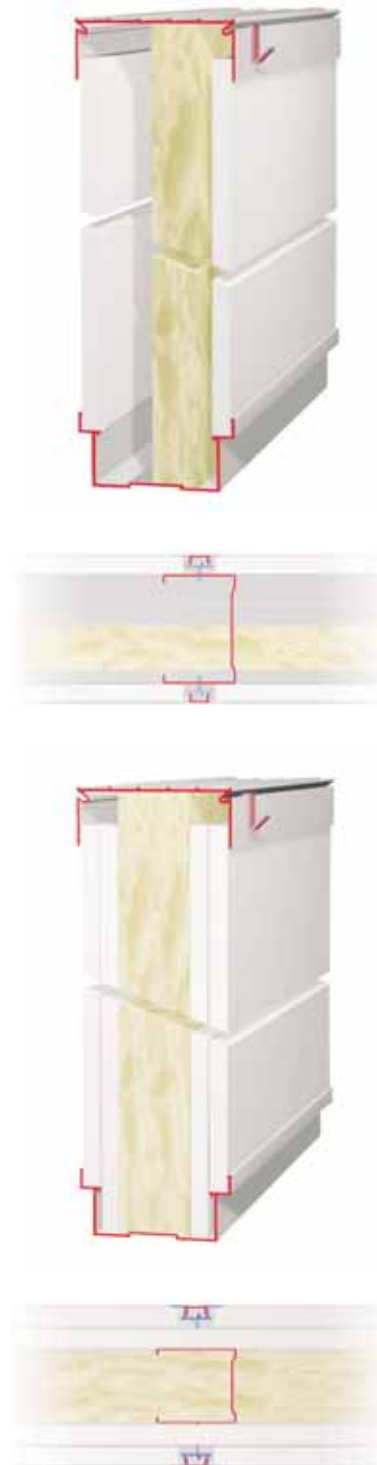

Interfinish the ultimate demountable solution

Your Interfinish specialist:

www.interfinish-int.com



Omega System

Technical Details

With the partition systems Omega and Omega-VIP Interfinish has conquered for many years a position on the market of stylish partition systems.

The Omega System offers a functional and solid solution in every space and makes it possible to organize space in the best and esthetically acceptable way.

The main characteristic of this partition is its omega shaped joint. This profile which features many different colours cover strips, forms a perfect joint between solid sections, glazed elements and doors. Its success has been gained by its very complete program with matching doors, glass elements and cupboard systems. Blinds both horizontal and vertical can be built into these double glazed glass elements. Certainly the attractive price is an additional advantage of this partition system.



The Omega System is a non-supporting, fire resistant construction with a basic modulation of 1200mm. The steel studs are positioned in the aluminium top and bottom tracks. The bottom track features a toe recess. Passage of cables, water ducts and data cables is possible. The top track features a built-in picture rail.

The Omega-VIP series is a special execution for spaces which require a high level of sound insulation. This special partition system is made with double layer plaster board panels without changing the thickness of the partition itself. Although a fairly high sound insulation level can be achieved, these additional panels guarantee an even higher value.

Both partition systems can be combined with additional components. Just like the other Interfinish partition systems the Omega and Omega-VIP can be obtained in many different executions.

Wall covering materials can be either vinyl or laminate and are also available in many different colours and executions.

Profiles and doors can be provided in many colours and styles. Interfinish the ultimate demountable solution.



Interfinish the ultimate demountable solution

Solid partitions are created by means of two plasterboard or chipboard panels. Between these panels a stud construction and mineral wool for insulation. Plasterboard or chipboard panels are screwed to the studs through an omega shaped profile. A PVC insert strip covers up the screws.

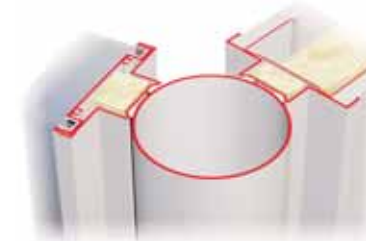
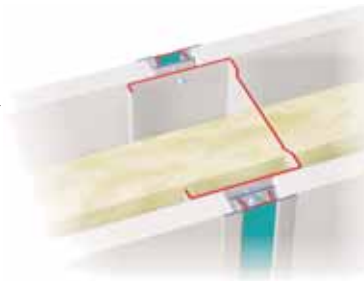

The corner posts are prefabricated for 90 and 135 degree angles.

Y-connections, wall end profiles and variable angle solutions in combination with special corner solutions, complete the flexible and variable executions.



The steel studs are provided with cut outs for cables, data and water ducts. All visible profiles are made in powder coated aluminium.

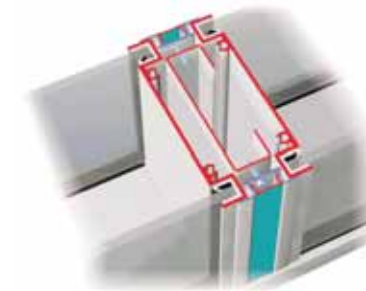

For these partitions we have a wide range of door solutions. Standard door leaves are flush and made of hollow-core chipboard. Ironmongery is included. The door frames are provided with three powder coated aluminium hinges with a steel core and insulation strip. A wide array of different solutions is available for handles and shields.

Glass elements are either single or double glazed and consist of an aluminium frame in which the glass panes are positioned in an insulating glazing bead. Many different glass types can be selected.

Both vertical and horizontal blinds can be installed between the two panes.

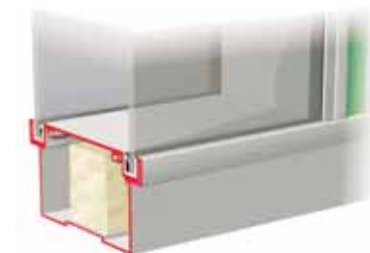

All systems are supplied pre-finished which makes installation possible in the very shortest time and eliminates painting and drying times. Alterations are possible even during working hours.